

Social Activity Nodes

Eco-walk encourages community bonding by enhancing the overall social/activity node network. From a physical connector, it transforms into roof gardens above the loft units, which provides all-day semi-public passive social/activity spaces overlooking the waterfront. Along the typical residential blocks, the Eco-Walk also provides pockets of spaces conducive for intimate conversations or individual contemplation.



Homemakers practicing yoga by the waterfront.



Su Ling & Elaine engaging in conversations before making their way home from school.



The Mok family catching up on the past week's happenings with each other over picnic.

KAMPONG-SCAPE

Reviving Gotong Royong



Courtyard Block Typical Plan

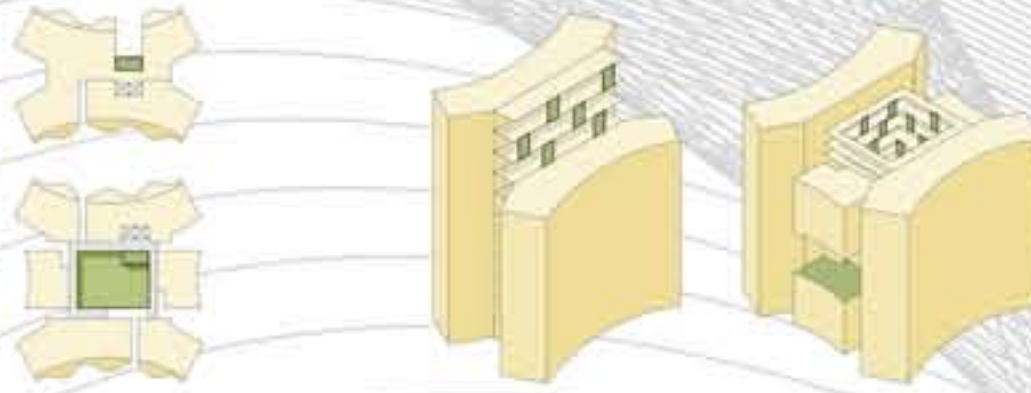

Located adjacent to the Lift Lobby of every 3 storeys and within atrium courtyard spaces. Vertical Green Screens along corridor, Landscaped Sky Decks & Roof Gardens.

SOCIAL + LANDSCAPED SPACES



Morning social activities around the green courtyard



Sky Deck - Where the community connects



Reminiscing Yesteryear - Reinstating the Eco-Friendly Landscape



Landscape Deck

Reintroducing activities of yesteryear's Punggol

1. Kelong Delight - Fishing village-inspired playground and fitness.
2. Forest Adventure - Forest themed playground and fitness centre for thrill seekers.
3. Plantation Fun - Have fun with the rubber tyres as play features and gardening containers.
4. Traditional Games Corner - All time favourite games for the whole family.
5. Kampong Trail - Discover various insects through play and experience walking barefooted in the kampong.

Facilities and activities for all ages are placed randomly throughout the deck to blending seamlessly into the landscape settings.



Eco Walk

Thematic gardens for passive activities that recall the native settings of Punggol.

6. The Fishing Village - Enjoy Tai Chi and yoga in this rustic garden integrated with timber decking and sand/slate.
7. The Grassland - A delightful garden featuring undulating plazas and lawns flanked by grass and soft plantings for reading, picnicking and gathering.
8. The Coastline - Enjoy a game of chess or a stroll in this tranquil garden embraced by stones, gravel and minimal planting.

Sky Garden

Private and exclusive gardens optimizing panoramic views of the waterway.

9. Sky Gym - Adult and elderly fitness equipments.
10. Sky BBQ - BBQ and social gathering.
11. Sky Terrace - Meditation and exercising.
12. Sky Lounge - Casual dining and reading.



Common Green

Reinstating eco-friendly landscape elements to complement the overall concept of creating a natural environment within the precinct.

13. Central Mat Seating Area - A transition space with dry pond as eco feature flanked by mist.
14. Terracing Landscape - A seamless connection responding to the level difference to promenade.
15. Staggered Seating Walls - As an amphitheatre facing the multi-purpose hard court.
16. Sand Play Area - Net play, flying fox, sand castle corner and a simple volleyball court.
17. Adult and Elderly Fitness - Exercising on higher ground with the refreshing view of the waterway.
18. Dry Stream - An eco feature for water filtration before discharge to waterway.
19. Community Plaza - Cozy shaded seating with small group activity space; Tai Chi, Line Dance.



Planting Concept



Ground Level @ 110 & 111.9

- Evergreen canopy trees with layers of lush undergrowth to simulate the magnificent rainforest. Integrated with bioswale to filter harvested rainwater.
- Wide spreading evergreen trees as a welcoming feature along the driveway.
- Lush cluster of medium size canopy trees with light foliage to create a porous and comfortable setting yet capturing the ambience of rainforest.
- Lush cluster of evergreen canopy trees and palms with straight trunks to resemble the Kelong stilts.
- Dense evergreen trees with conical form to create visual screening to the adjacent MRT station and road.
- Neatly planted trees and shrubs in rows to echo the setting of a plantation.
- Mixed planting with a variety of species comprised mainly of edible and utilitarian plants to create a familiar kampong environment.
- Evergreen canopy trees integrate with undulating open lawn. Plants with soft texture that rustle in the breeze to capture the setting of grassland.
- Minimal planting with predominantly evergreen canopy trees. Shrubs with white tone to reflect the serenity of the coastal land.
- Elegant palms and flowering canopy trees with light foliage are strategically placed to open up towards the view of the waterway as well as provide sufficient shades.